



# 901 N. LINCOLN

Office Space for Lease

Available for  
Occupancy  
May 2010

This newly constructed office building at **901 N. LINCOLN** continues the uninhibited growth of the Oklahoma Health Center. The first two floors of this new building are currently occupied by the Oklahoma Blood Institute's administrative offices, a donor room, and a Midfirst Bank branch, leaving 16,835 square feet of space available for lease on the top floor. The entry plaza is highlighted with an enclosed glass lobby and two-story atrium. **901 N. LINCOLN** was built with the highest quality finishes and amenities including a 2,500 square foot conference and training room.



Northeast Elevation



Gerald Marshall Conference Center

# 901 N. LINCOLN

## Gateway to the Oklahoma Health Center



901 N. LINCOLN is located at the gateway to the Oklahoma Health Center, which is considered the epicenter of research, healthcare, education, technology and community service organizations in the state of Oklahoma. This 300 acre area represents the second largest concentration of employees in Oklahoma with over 12,500.

Located just a few blocks south of the Oklahoma State Capitol and minutes from downtown Oklahoma City, Bricktown, and Midtown, it also has quick access to the entire metropolitan area via I-235, I-40 and I-35.



Garden Area



Main Entry Plaza



For more information on  
this property, go to:  
[www.wigginprop.com/901lincoln](http://www.wigginprop.com/901lincoln)  
or contact:



Sam Vinall  
**WIGGIN**  
PROPERTIES, LLC

5801 N. Broadway, Suite 120 • Oklahoma City, OK 73108  
405.842.0100 • [svinall@wigginprop.com](mailto:svinall@wigginprop.com)

- ◆ First-class office space ranging in size from 1,000 to 16,835 square feet is ready to be designed to your exact specifications.
- ◆ 2,500 square foot conference/training room on ground floor available to all tenants.
- ◆ Nine foot ceilings on the entire upper floor with great views and plenty of natural light.
- ◆ Abundant free parking.
- ◆ Located at the gateway to the Oklahoma Health Center, the second largest concentration of employees in Oklahoma.
- ◆ Quick and easy access to and from Broadway Extension/I-235 from both 6th Street and 10th Street.

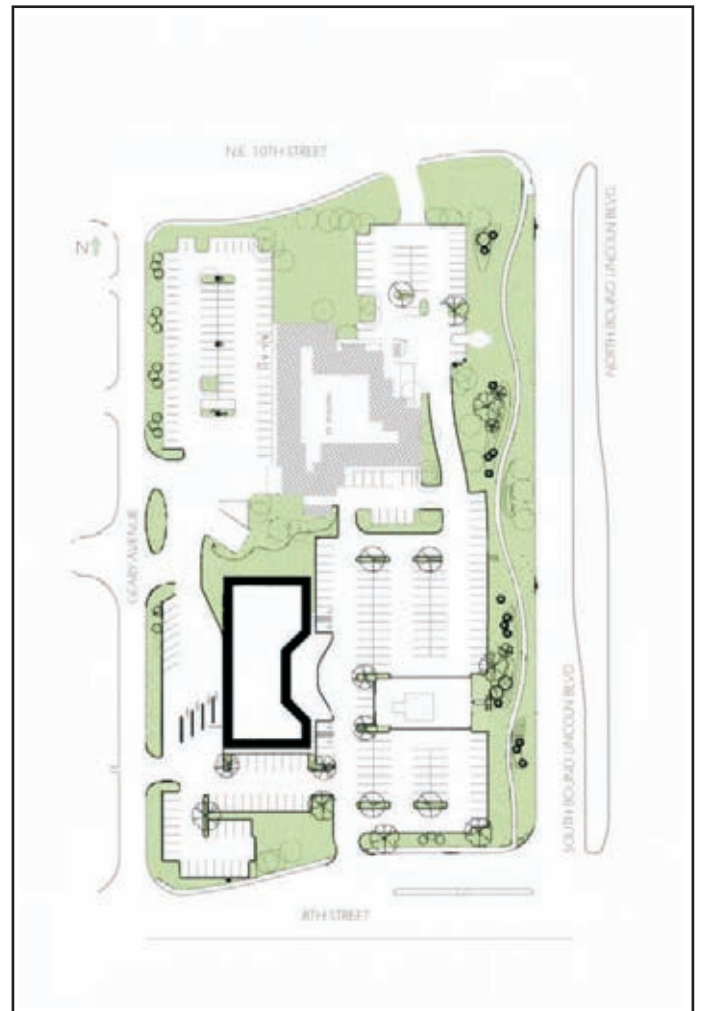

The information provided on this property is for information purposes only. It is from sources believed to be reliable. However, Wiggin Properties makes no warranties or representations, expressed or implied, as to the accuracy or sufficiency of the information. It is presented subject to errors, omissions, changes, or withdrawal without notice.